

# FOR LEASE

URBAN  
WORKS

# Memori

1010 SE ASH ST | PORTLAND

AVAILABLE SPACE | 1,435 SF - 1,595 SF



RESTAURANT



RETAIL



CAFE

## RETAIL / RESTAURANT OPPORTUNITIES ADJACENT TO SOHO HOUSE

DAN BOZICH | 503.228.3135  
dbozich@urbanworksrealestate.com

KIA HARTLEY | 503.228.3209  
khartley@urbanworksrealestate.com

urbanworksrealestate.com

**Address**                      **Area**

1010 SE Ash St              Buckman

**Available Spaces**

1,435 SF - 1,595 SF

**Uses**

Restaurant / Retail / Cafe

**About**

Two new retail suites now available on the ground floor of the new Memoir Buckman residential building. Situated adjacent to Soho House, these suites present a prime opportunity for select retailers to establish themselves in one of East Portland’s most vibrant neighborhoods.

- **Suite A:** Occupying a corner location at SE Ash Street and SE 11th Avenue, this suite boasts a striking glass storefront that floods the space with natural light.
- **Suite B:** Ideally suited for a food vendor. Both suites are currently in a “cold shell” condition with access to shared restrooms.

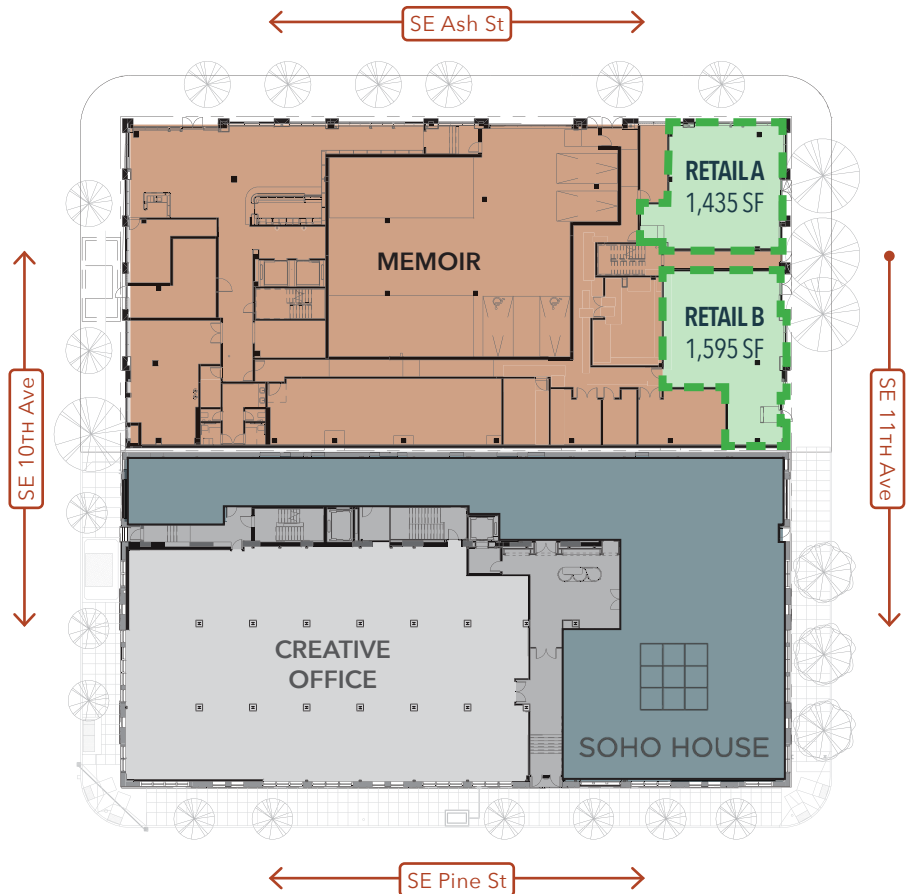

**Soho House Portland** | A private members’ club located in the historic Troy Laundry Building in the heart of Portland’s Central Eastside district. This is the Pacific Northwest’s first Soho House and offers amenities like a rooftop pool, gym, restaurant and lounge. Membership provides access to this exclusive social and recreational space.



Retail A Storefront Windowline

# NEIGHBORHOOD



Demographics	¼ Mile	½ Mile	1 Mile
2024 Population	2,082	8,381	28,410
Total Employees	2,838	11,665	51,568
Total Businesses	386	1,458	4,907
Median Household Income	\$89,711	\$70,768	\$77,416
Median Age	32.9	33.2	36.2
Any College	89.1%	86.1%	82.5%

**Buckman** | Buckman is a charming, artsy industrial neighborhood in the Central Eastside of Portland. The neighborhood is known for its unique mix of textures: industrial buildings are mixed with tree-lined streets that feature rows of colorful historic homes. There are several parks in Buckman and overall walkability is excellent. Buckman's culinary scene is also booming; the neighborhood is now home to several James Beard nominated restaurants, as well as several of the city's best cocktail and dive bars. Memoir Buckman is adjacent to the new Soho House Portland - the first Pacific Northwest location for Soho House.

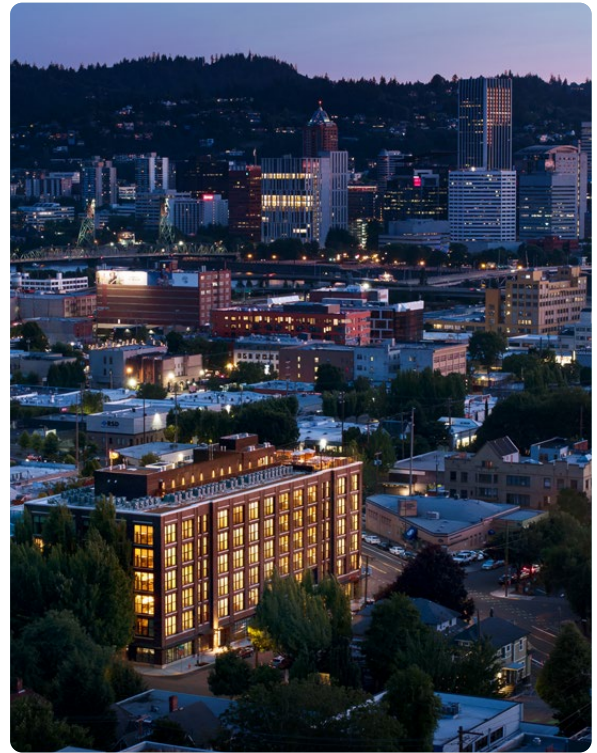

INFORMATION CONTAINED HEREIN IS FROM SOURCES DEEMED RELIABLE, BUT NOT GUARANTEED.